

### 3 INSTALLATION

※ Based on the condition and place, the installation procedures could be varied.

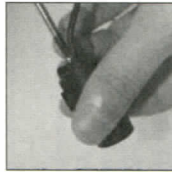

(1) Verify the position of 'TOP' which should be upper side and fix it to the lens bracket with screws.

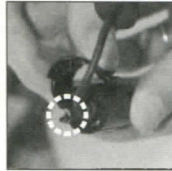

(2) Then install it to the bottom bracket.



(3) Select and clean the position for the camera installation.



(4) Fix the pre-installed camera using the rubber packing and screws.



(5) Then cover it with the camera housing like the picture.

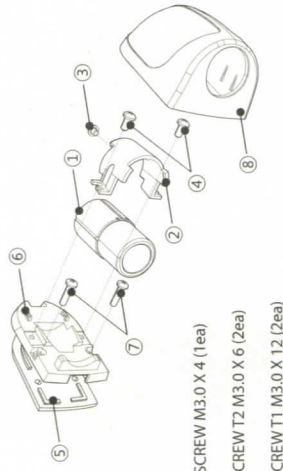

 MACHINE SCREW M3.0 X 4 (1ea)

 TAPPING SCREW T2 M3.0 X 6 (2ea)

 TAPPING SCREW T1 M3.0 X 12 (2ea)

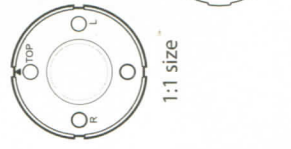

 When install CS-110 camera, place "TOP" face to upside.

## 4 CONNECTION

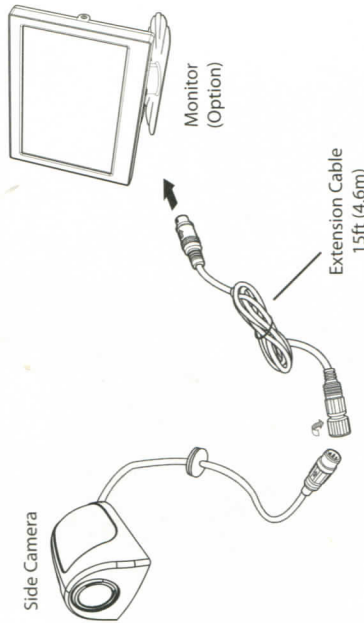

 Before making the connection, disconnect the ground terminal of the car battery to avoid short circuiting.

 Before inserting plug, should check pin specification and the plug should insert to jack or connector firmly.  
If forced insert wrong direction, it may cause malfunction.

 When connect extension cable, turn it right direction as described arrow.

### CS-110 CAMERA CONNECTOR

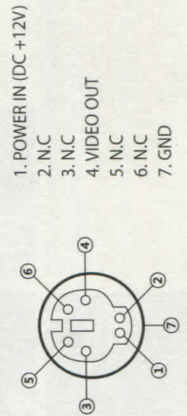

## 5 CLEANING & GENERAL MAINTENANCE

※ If your vehicle has been parked in direct sun light resulting in a considerable rise in temperature inside the vehicle, allow the unit to cool off before operating.

### CLEANING

Unplug or power off mode before cleaning. Do not use liquid cleaners or aerosol cleaners. Use a damp cloth for cleaning.

### OBJECT AND LIQUID ENTRY

Never push objects of any kind into this monitor equipment through holes as they may touch dangerous voltage points or short-out parts that could result in a fire of electric shock. Never spill liquid of any kind on the product.

### SERVICING

Do not attempt to service this system by yourself as opening or removing covers may expose you to dangerous voltage or other hazards. Refer all servicing to qualified service personnel.

## 6 SPECIFICATION

Image device (NTSC/PAL)	1/4" IT COLOR CCD Image Sensor
View of angle (H/V/D)	71/47/74 deg
Minimum illumination	1Lux
Input Voltage	DC 5V~15V/100mA max @ 12V
Operating temperature	-4°F to 122°F / -20°C to 50°C
Camera Weight	0.18lb (79.5g)
Dimension	2.44(W) x 1.18(H) x 1.57(D) inch
	62(W) x 30(H) x 40(D) mm
Accessories	Bottom Rubber ..... 1
	Screws set ..... 1
	Extension Cable ..... 1